



PAINTED TREE

McKINNEY TEXAS

COMMUNITY GUIDE

a journeyer's companion

A trailside community

is closer than you think.



*Map not to scale

PAINTED TREE

3 miles northwest of Downtown McKinney, Texas
PaintedTreeTX.com



A COMMUNITY BY OXLAND GROUP

Painted Tree is currently under development by Oxland Group — statements and images are conceptual in nature, subject to change without notice, and are provided for general informational purposes only and shall not be relied upon.

© 2022 Painted Tree, McKinney, Texas | EQUAL HOUSING OPPORTUNITY



DOWNTOWN McKINNEY

Rooted in Texas hospitality and blooming with creativity is historic Downtown McKinney. Imagine: live music, eclectic boutiques, mouth-watering eats and more just three miles from your front door.



TWO PUMP TRACKS— ALL AGES

Have a two-wheeled adventure with two pump tracks, one for advanced mountain bikers and one just for the younger crowd.



Breathe

THE GREAT OUTDOORS

Two hundred and fifty acres. That's how much we've set aside for parks, trails and the all-around grandness of the world outside. Isn't it funny how easily our natural habitat can become habit?

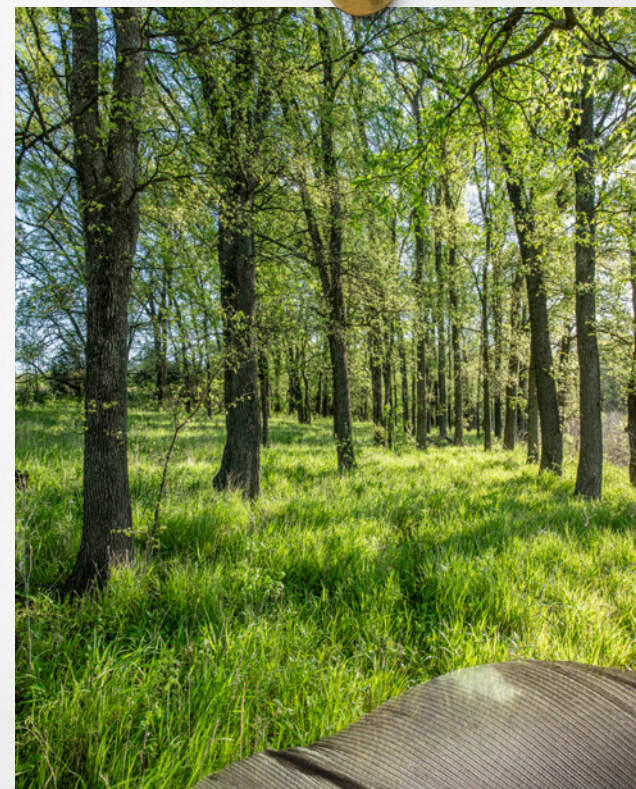

McK — TEX

PAINTED TREE

3 THE VILLAGE TRAILHEAD

Some days are made for exploration. Some days are made for relaxation. The Village Trailhead offers a bit of both. Relax and recharge with this pool's sun shelf and water feature. Or get the blood pumping on its pump track. Either way, you're in for one wonderful day. Planned 2023.



SMART BY NATURE

McKinney Independent School District schools are known for their outstanding arts programs, well-rounded curriculum and competitive athletic teams. While a variety of exceptional private and charter schools — including a new Montessori school within the community — offer students different paths to academic success.

2 THE LAKESIDE TRAILHEAD

Water, water everywhere. The Lakeside Trailhead features a relaxing two-tiered pool, comfortable lounges and an open-air pool house. And for those who would rather soak up a bit of the starry night sky, gathering around the fire pit is an excellent option. Planned 2023.

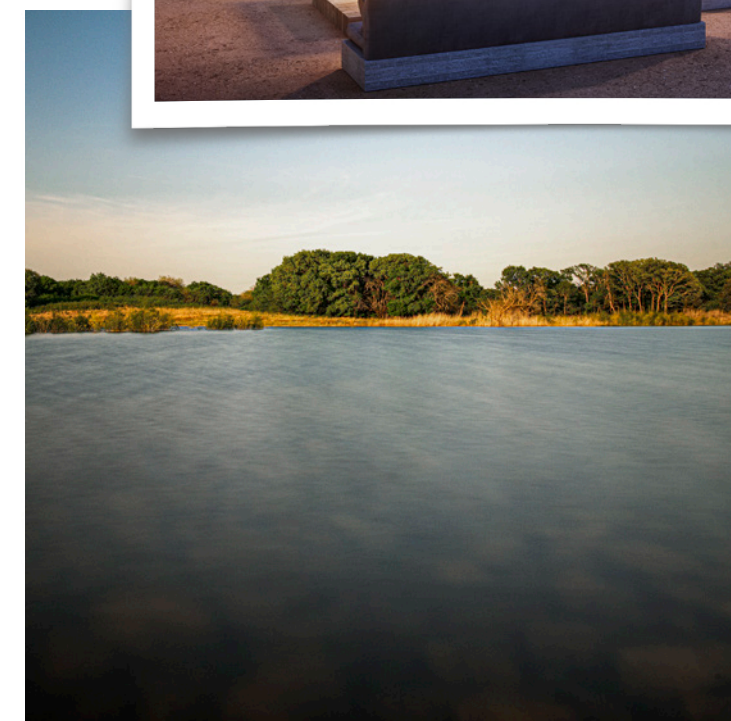

A NICE, BIG LAKE

Shimmering water has a way of carrying the day's stresses away. At 20 wonderful acres, Painted Tree Lake should do quite nicely.



WHEN THE DAY CAN TAKE YOU ANYWHERE, RIGHT HERE IS A GOOD PLACE TO START

Just a smidge northwest of historic downtown McKinney, a new kind of community is taking shape. Where carefully considered gathering spaces encourage adventure, exploration and relaxation. Neighbors connect over s'mores, under stars. And all kinds of distinct homes are nestled among three unique districts. We call it a trailside community. And there's much more to be explored.

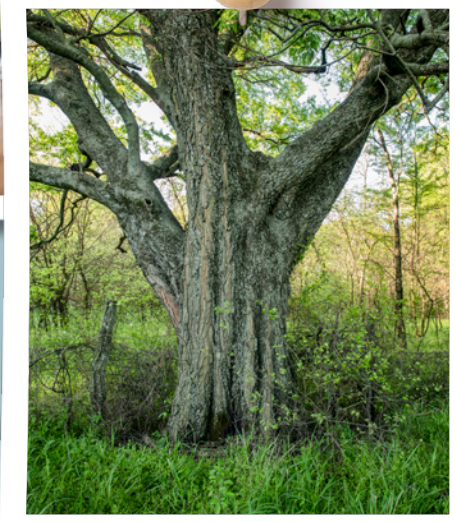
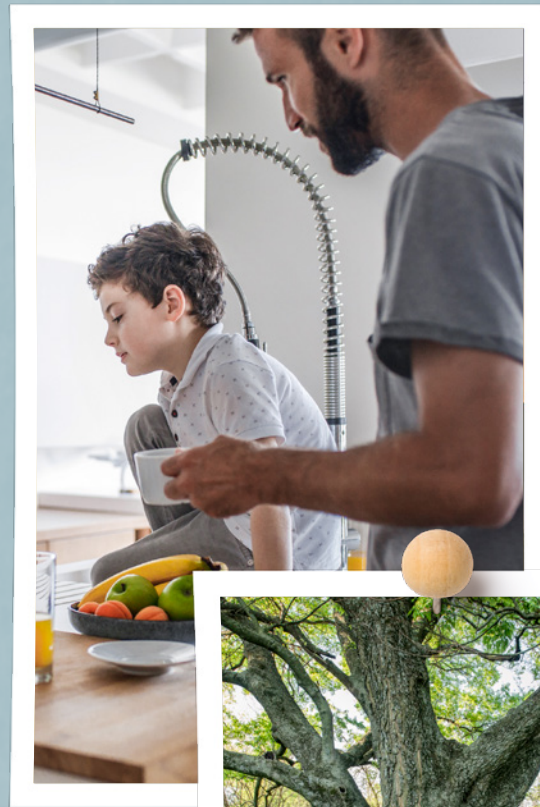

No matter how you
move through nature,
it's sure to
move you back.

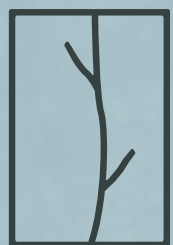

PAINTED TREE

McKINNEY TEXAS

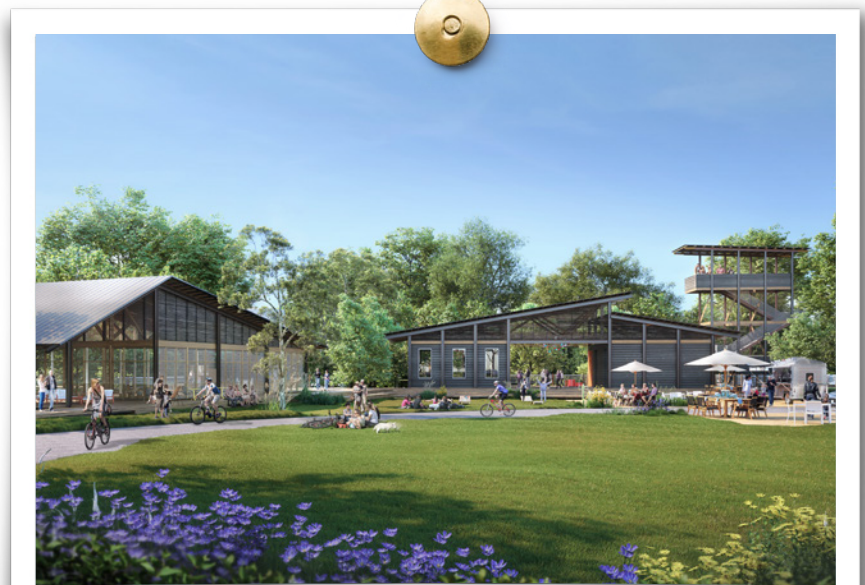

Map is not to scale and is intended for informational and illustrative purposes only. Plans, uses, zoning, amenities, features, availability, acreage, sizes, dates, builders, and other elements are subject to change by Oxland Group or its affiliates without notice, and shall not be relied upon. 09/22