

PAINTED
TREE

McKINNEY TEXAS



COMMUNITY
GUIDE

a journeyer's companion

A trailside community

is closer than you think.



PAINTED TREE

3 miles northwest of Downtown McKinney, Texas

PAINTEDTREETX.COM



A COMMUNITY BY OXLAND GROUP

Painted Tree is currently under development by Oxland Group — statements and images are conceptual in nature, subject to change without notice, and are provided for general informational purposes only and shall not be relied upon. May 2023

© 2023 Painted Tree, McKinney, Texas | EQUAL HOUSING OPPORTUNITY

THE GREAT OUTDOORS

Two hundred and fifty acres. That's how much we've set aside for parks, trails and the all-around grandness of the world outside. Isn't it funny how easily our natural habitat can become habit?



SMART BY NATURE

McKinney Independent School District schools are known for their outstanding arts programs, well-rounded curriculum and competitive athletic teams. While a variety of exceptional private and charter schools offer students different paths to academic success, including Learning Tree Montessori within Painted Tree.

2 LAKESIDE TRAILHEAD

Water, water everywhere. Lakeside Trailhead features a relaxing two-tiered pool, comfortable lounges and an open-air pool house. And for those who would rather soak up a bit of the starry night sky, gathering around the fire pit is an excellent option. Coming summer 2024.

PAINTED
TREE

3 VILLAGE TRAILHEAD

Some days are made for exploration. Some days are made for relaxation. Village Trailhead offers a bit of both. Relax and recharge with this pool's sun shelf and water feature. Or get the blood pumping on its pump track. Either way, you're in for one wonderful day. Open summer 2023.



Breathe

PUMP TRACKS

Have a two-wheeled adventure with two pump tracks, one for advanced mountain bikers and one just for the younger crowd.

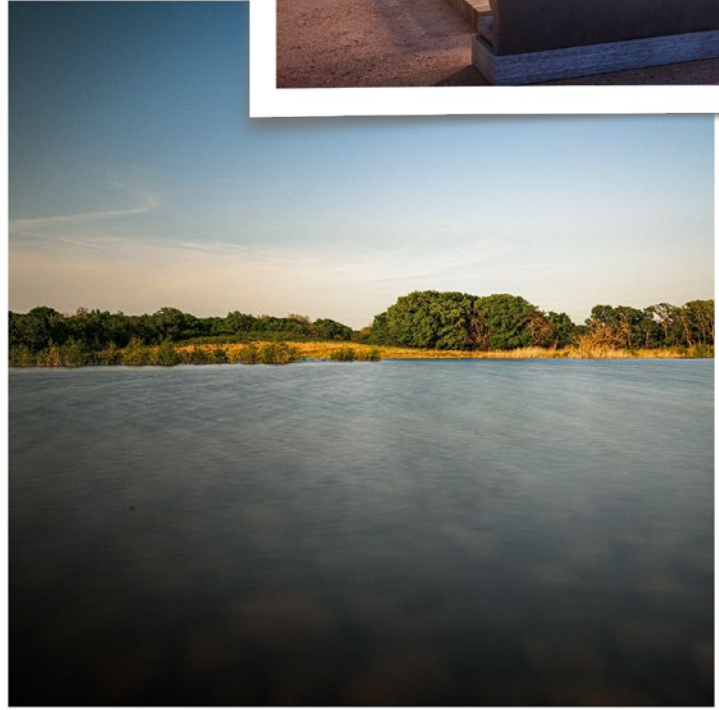

A NICE, BIG LAKE

Shimmering water has a way of carrying the day's stresses away. At 20 wonderful acres, Painted Tree Lake should do quite nicely.



WHEN THE DAY CAN TAKE YOU ANYWHERE, RIGHT HERE IS A GOOD PLACE TO START

Just a smidge northwest of Historic Downtown McKinney, a new kind of community is taking shape. Where carefully considered gathering spaces encourage adventure, exploration and relaxation. Neighbors connect over s'mores, under stars. And all kinds of distinct homes are nestled among three unique districts. We call it a trailside community. And there's much more to be explored.



No matter how you
move through nature,
it's sure to
move you back.

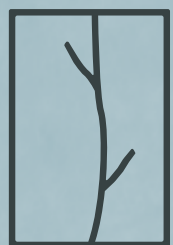

PAINTED TREE

McKINNEY TEXAS

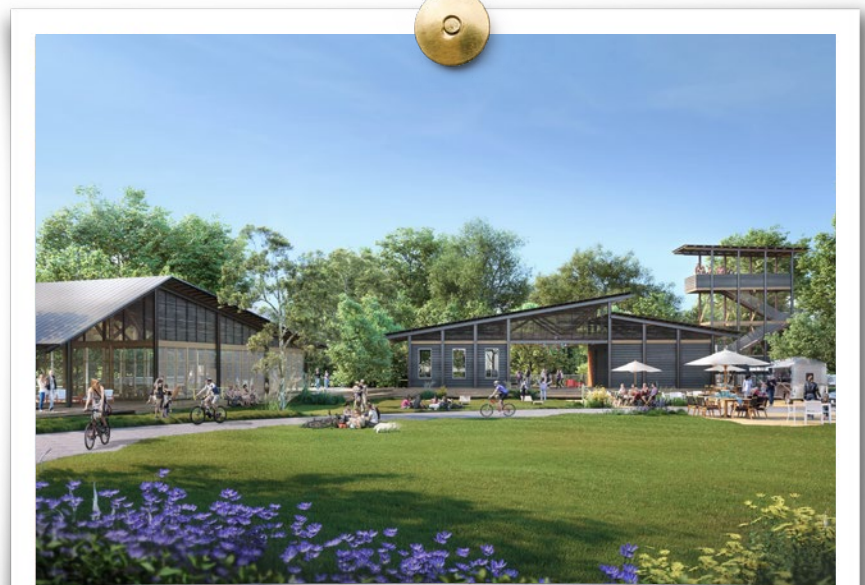

Map is not to scale and is intended for informational and illustrative purposes only. Plans, uses, zoning, amenities, features, availability, acreage, sizes, dates, builders, and other elements are subject to change by Oxland Group or its affiliates without notice, and shall not be relied upon. 05/23