

Painted Tree - Woodland West

BRICE II | 2,165 Sq. Ft.* | 3 | 3 | 2



FIRST FLOOR - ELEVATION A*



All home plans and renderings are for illustrative purposes only and are not to scale. Dimensions, square footage and specifications may vary and are subject to change without notice. Structural and elevation options can change room count and square footage. Variations in layout, design, and finishes may occur based on home site, elevation, and other factors. Measurements are approximate and can vary at final construction. Normandy Homes reserves the right to discontinue plans or make changes and substitutions as necessary to meet building code requirements, site conditions, or other requirements. Please contact the Community Sales Manager for complete details. 09.06.2024 © 2025 Normandy Homes. All rights reserved. Normandy Homes is a subsidiary of Green Brick Partners (NYSE: GRBK).

Painted Tree - Woodland West

BRICE II | 2,165 Sq. Ft.* |  3 |  3 |  2

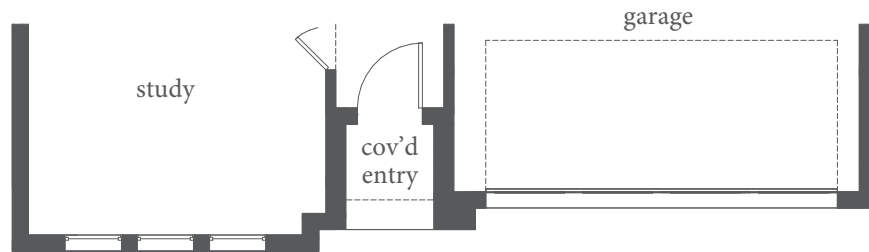

FIRST FLOOR - ELEVATION B

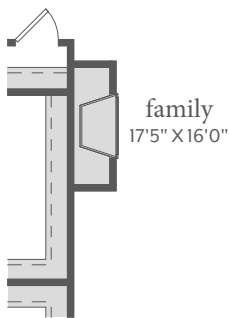
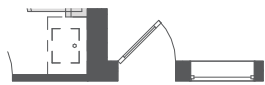

OPT. FIREPLACE

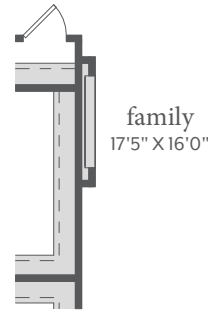

OPT. ELECTRIC FIREPLACE

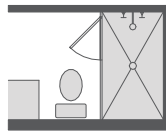

OPT. SHOWER ILO TUB
BATH 2 & 3



All home plans and renderings are for illustrative purposes only and are not to scale. Dimensions, square footage and specifications may vary and are subject to change without notice. Structural and elevation options can change room count and square footage. Variations in layout, design, and finishes may occur based on home site, elevation, and other factors. Measurements are approximate and can vary at final construction. Normandy Homes reserves the right to discontinue plans or make changes and substitutions as necessary to meet building code requirements, site conditions, or other requirements. Please contact the Community Sales Manager for complete details. 09.06.2024 © 2025 Normandy Homes. All rights reserved. Normandy Homes is a subsidiary of Green Brick Partners (NYSE: GRBK).